

Requirements for Commercial and Residential Sidewalk Placement

1. Concrete sidewalks not less than four (4) inches in thickness and (4) feet in width shall be constructed within the street right-of-way and adjacent to the property line.
2. All sidewalks shall be a concrete section across the entire breadth and width at driveways or entryways and shall be of a thickness equivalent to the street cross-section. Minimum thickness shall be six (6) inches. Six (6) bag mix with two (2) inch clean limestone rock sub-base on compacted subgrade, per IDOT standards, is required.
3. All sidewalks shall be accessible to the handicapped in accordance with the Americans with Disabilities Act (ADA) and the Illinois Accessibility Code. At locations where the sidewalk crosses entryways, the entryway must conform to ADA requirements. In the case of conflict, the more stringent requirements shall apply. Curb ramps accessible to the disabled shall be provided in accordance with the current edition of IDOT Standard 424001. A pre-cast detectable warning tile of Federal standard brick red color shall be placed in the ramp. The entire concrete ramp surface no longer is required to be red.
4. All sidewalks shall be poured separately from entryway pavement and in addition, joint material shall be placed to a depth of six (6) inches to separate the entryway pavement from the sidewalk.
5. Public Sidewalk Pre-Inspection: Made after excavation, placement of forms and base preparation is completed, and prior to placing concrete.
Call the Engineering Group at 618-624-4500 Ext. 3 for inspection.

Items checked at time of inspection:

Set back from back of curb shall be in accordance with approved Development Plans on file with the City of O'Fallon.

For the slope of this area see detail provided.

Base shall be stable and free of any mud, standing water or debris etc.

Depth shall be a minimum of 4" for sidewalk and 6" for sidewalk through entryways.

Width of sidewalk shall be 4' unless otherwise specified and approved.

Slope of sidewalk 1/8" per foot minimum and 1/4" per foot maximum.

6. See details on the following pages and direct any questions to the Engineering Group at 618-624-4500 Ext. 3.

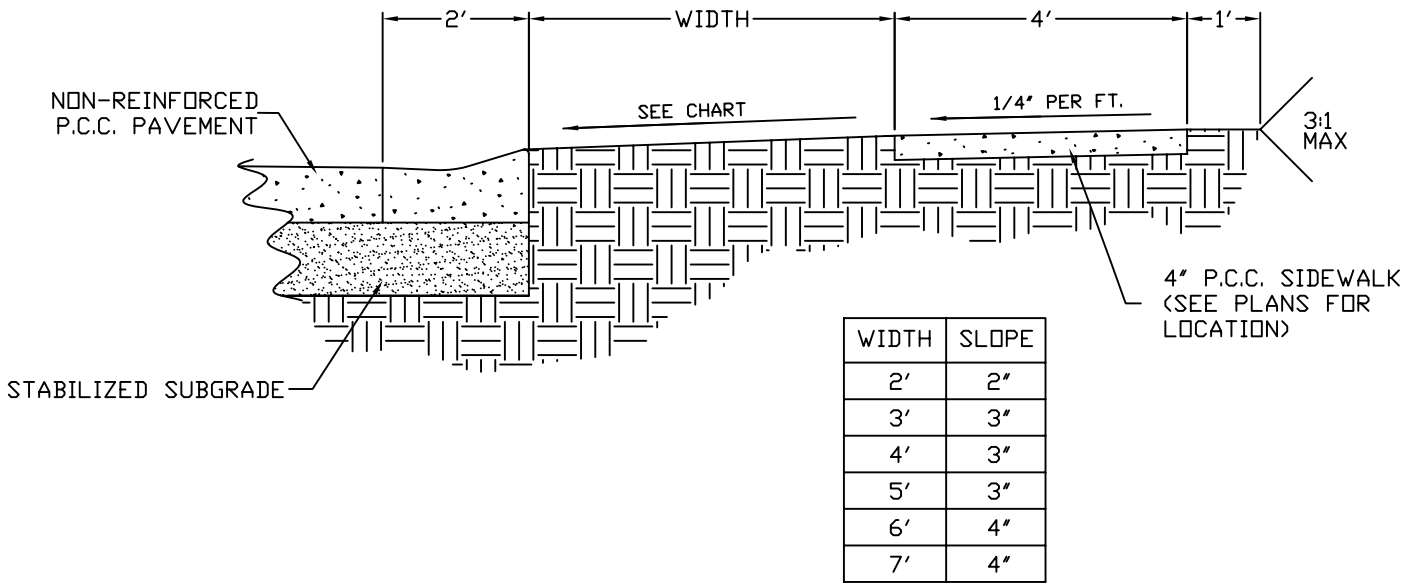

SIDEWALK DETAIL

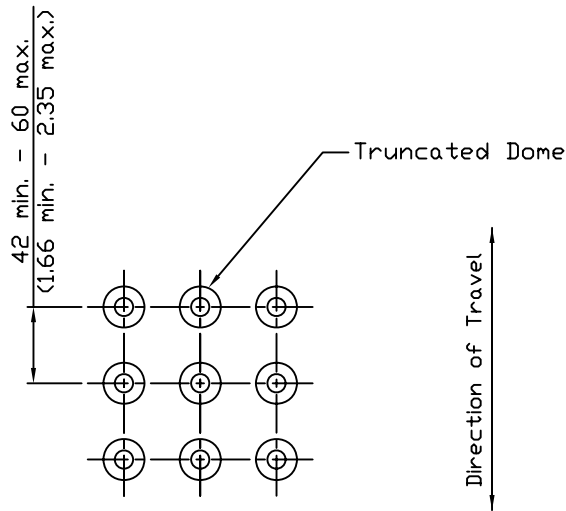

SQUARE PATTERN
(Parallel Alignment)

DETECTIBLE WARNINGS DETAIL

NOTE: THE DETECTABLE WARNING OF AN ADA ACCESSIBLE RAMP SHALL CONSIST OF A RAISED TRUNCATED DOMES WITH A DIAMETER OF 0.9', A HEIGHT OF NOMINAL 0.2', AND A CENTER-TO-CENTER SPACING OF 1.66' TO 2.35' AND SHALL CONTRAST VISUALLY WITH ADJOINING SURFACES. THE DETECTABLE WARNING SHALL BE A BRICK RED INSERT OF CAST-IN-TACT OR FIBERGLASS MATERIAL. STAMPED DETECTABLE WARNINGS WILL NOT BE ALLOWED.

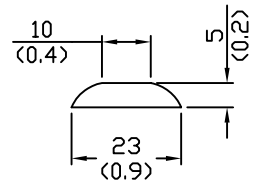

TRUNCATED DOME DETAIL

City of O'Fallon
Engineering Department

SIDEWALK DETAIL &
DETECTABLE WARNING
DETAIL
n.t.s.

DRAWING No.
APPENDIX
D

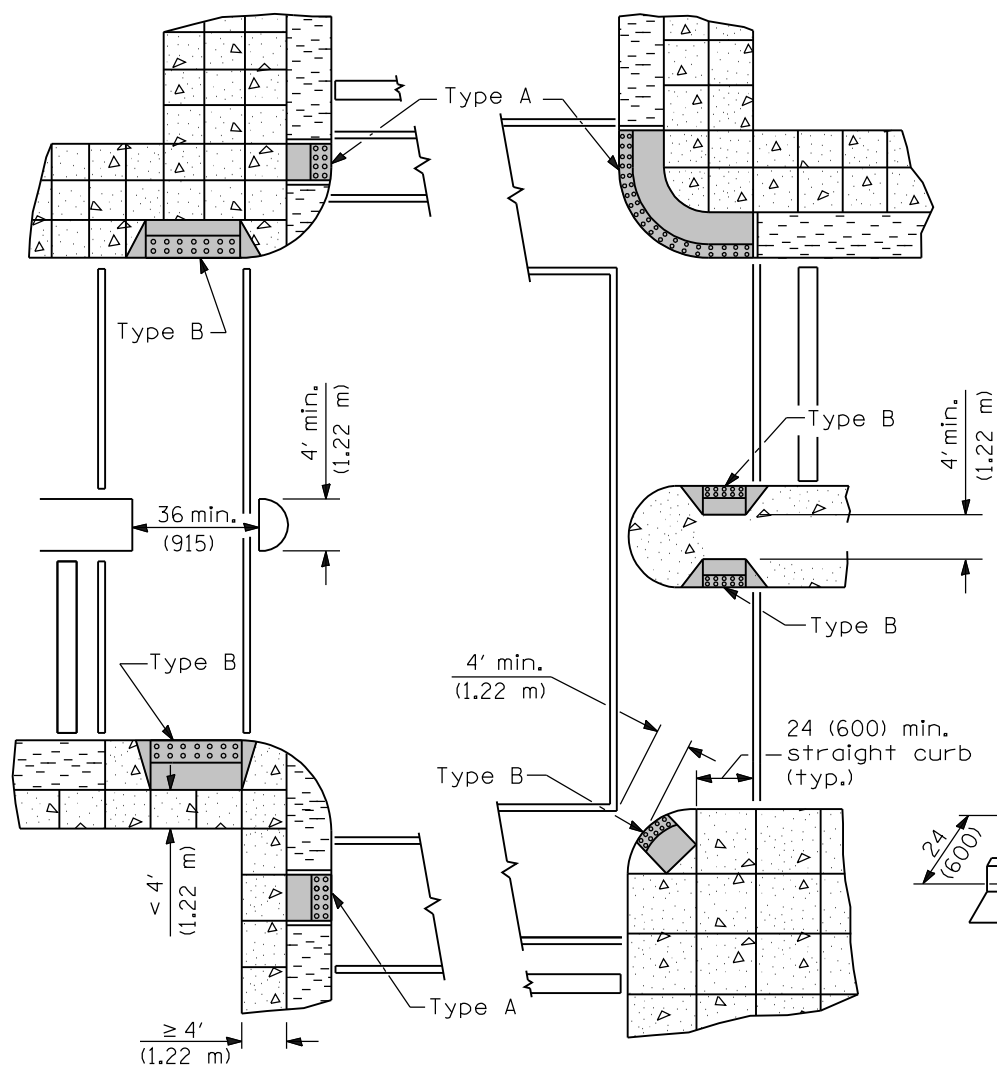

RECOMMENDED LOCATION OF RAMPS

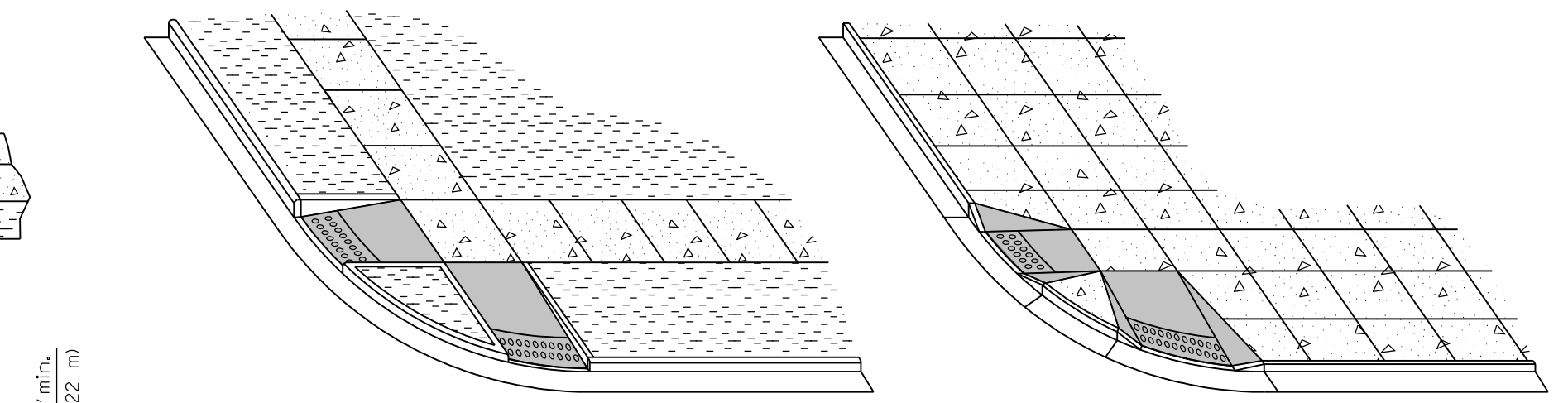

TYPE A RAMPS

TYPE B RAMPS

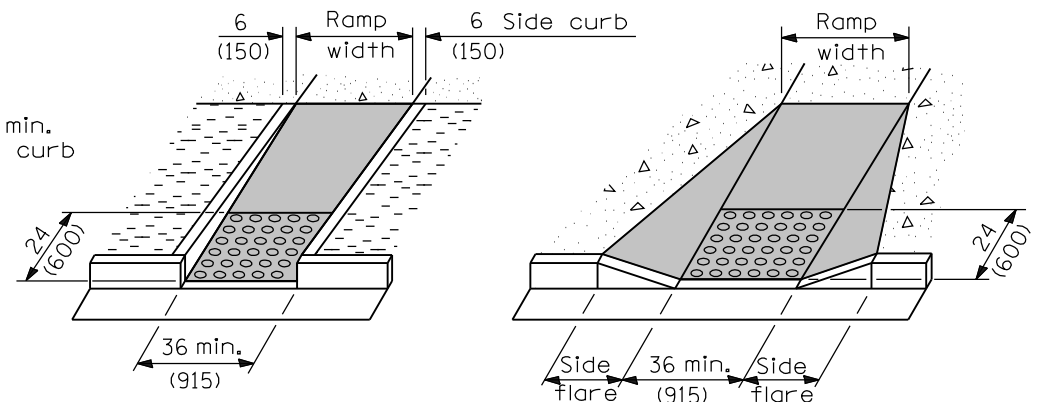

TYPE A

TYPE B

DETAILS OF RAMPS

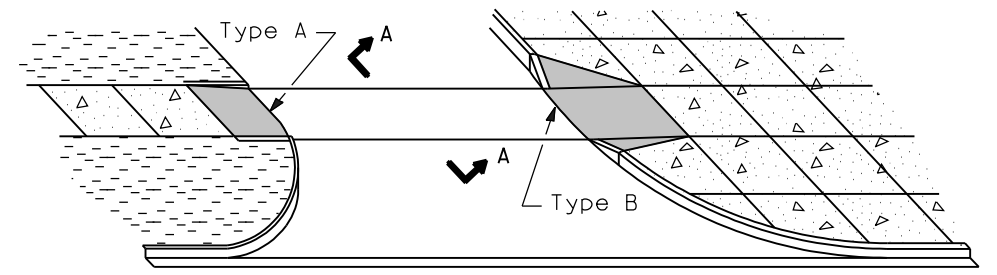

RAMPS AT ALLEYS OR ENTRANCES

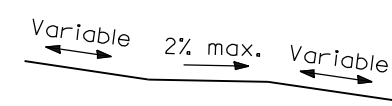

SECTION A-A

GENERAL NOTES

Detectable warnings shall be installed at curb ramps, medians and pedestrian refuge islands, at-grade railroad crossings, transit platform edges, and other locations where pedestrians are required to cross a hazardous vehicular way. Detectable warnings shall also be installed at alleys and commercial entrances when permanent traffic control devices are present.

The maximum slope of the side flare for Type B ramps shall be 1:10; however, if the width of the landing area between the top of the ramp and an obstruction is less than 4'-0" (1.22 m) then the maximum slope shall be 1:12.

All slope ratios are expressed as units of vertical displacement to units of horizontal displacement (V:H).

All dimensions are in inches (millimeters) unless otherwise shown.

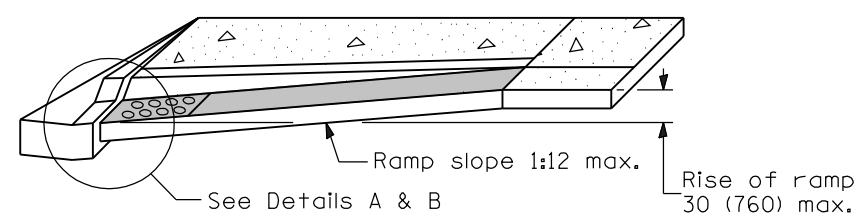

RAMP PROFILE

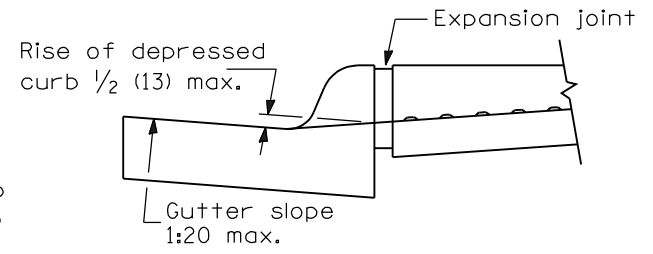

DETAIL A

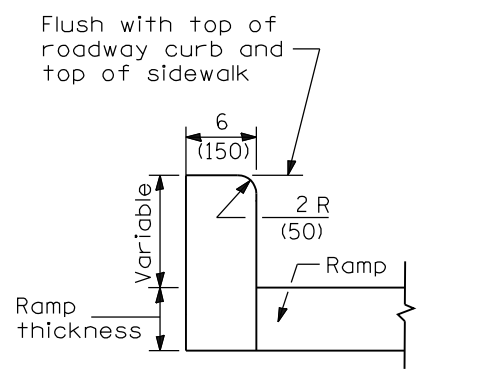

DETAIL OF SIDE CURB

(Side curb may be constructed monolithically with ramp)

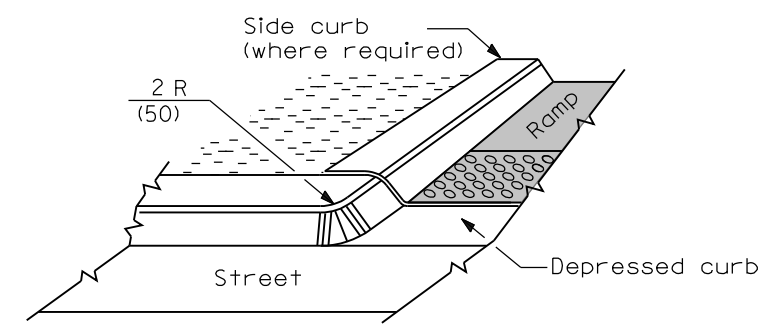

DETAIL B

LEGEND

- Sidewalk
- Ramp
- Detectable Warnings
- Non walking area

DATE	REVISIONS
1-1-08	Switched units to English (metric).
8-1-05	Revised placement of detectable warnings.
	title.

CURB RAMPS FOR SIDEWALKS

(Sheet 1 of 2)

STANDARD 424001-05

Illinois Department of Transportation

PASSED January 1, 2008
Scott S. Kelly
 ENGINEER OF POLICY AND PROCEDURES

APPROVED January 1, 2008
Ken E. Han
 ENGINEER OF DESIGN AND ENVIRONMENT

ISSUED 1-1-07